

Shadow Infrared Ceramic Heater

Safety Instructions and Operation Manual

901786, 901787

HEAT
indoors

Heat Outdoors
Unit 9, Stort Valley Industrial Estate
Stansted Road, Bishop's Stortford
Hertfordshire, United Kingdom
CM23 2TU

www.heat-outdoors.co.uk
01279 466500
info@heat-outdoors.co.uk



Brief Introduction

This product is infrared radiant heater with remote control and IP65 approved. It is almost unlimited in use for indoor and outdoor applications.

Important Safety Instructions

When using electrical appliances, basic safety precautions should always be followed to reduce the risk of fire, electric shock, or injury to persons, including the following:.

When using electrical appliances, basic safety precautions should always be followed to reduce the risk of fire, electric shock, or injury to persons, etc.

Read through the operation and assembly instructions conscientiously before operating the appliance. Be sure to keep the manual in a safe place for future reference. If you pass the appliance on, pass on the instructions too.

- Check if the voltage indicated on the nameplate of the appliance corresponds to the local mains voltage before you connect the appliance.
- The power supply to the appliance should correspond to the relevant regulations of the power supply companies and the regional construction regulations. Extension cords and multi-sockets may be used only if care is exercised in their use. The marked electrical rating of the extension cord or multi-socket should have adequate current carrying capacity and correspond to the relevant regulations of the power supply companies and the regional construction regulations. Check if the voltage indicated on the appliance corresponds to the marked electrical rating of the extension cord or multi-socket before you connect the appliance.
- Ensure the appliance is not located immediately below a wall socket/outlet.
- Never install this appliance close to anything combustible material such as curtains or other soft furnishings etc.
- In order to avoid overheating and a fire hazard, do not cover or obstruct the appliance. Do not put any of the following materials on the appliance: clothes, blankets, pillows or paper.
- The appliance will become extremely hot during operation. Pay attention that no combustible material covers or obstructs the appliance.
- Do not touch the appliance. Caution! Risk of scalding!
- Do not let the cord hang over edge of table or counter, or touch hot surfaces.
- If the supply cord is damaged, it must be replaced by the manufacturer or its service agent or a similarly qualified person in order to avoid a hazard.
- In case of improper use, there is a risk of electrical shock and/or fire hazard. Operation of the appliance must be stopped and remove the mains plug immediately. Do not try to repair the appliance by yourself. Please contact with the service agent or a suitably qualified electrician for maintenance.

- Remove the plug from the power outlet and wait until the appliance is sufficiently cooled off before cleaning.
- This appliance is not intended for use by persons (including children) with reduced physical, sensory or mental capabilities, or lack of experience and knowledge, unless they have been given supervision or instruction concerning use of the appliance by a person responsible for their safety.
- Keep out of reach of children. In order to keep children from the dangers of electrical appliances, never leave them unsupervised with the machine. Consequently, when selecting the location for your machine, do so in such a way that children do not have access to the machine. Children being supervised not to play with the appliance
- Do not use this heater with a programmer, timer, separate remote-control system or any other device that switches the heater on automatically, since a fire risk exists if the heater is covered or positioned incorrectly.
- The fireguard of this heater is intended to prevent direct access to heating elements and must be in place when the heater is in use

Installation

- For additional protection the installation of a residual current device (RCD) is advisable.
- Remove all package material (including anti-vibration object of the lamp) and check the appliance, supply cord and the plug for signs of damage.
- Pay attention to the mounting place and all mounting materials (dowels, screws). Ensure they are suitable and stable enough for mounting and holding of the appliance.
- Before mounting, the minimum safe mounting distances and tilt angles shown in the figures must be followed.
 1. The distance between the bottom edge of the appliance and the floor must be at least 1.8m
 2. There must be a distance of at least 0.2m between the appliance and the ceiling, roof or other covers.
 3. There must be a distance of at least 0.5m at each side between the appliance and adjacent walls. See figure 2.
 4. Remember the degree to mounting surface is 45°
- Fix the mounting bracket on the wall first. Ensure that the area of installation is secure and stable.
- Adjust the desired angle of heat and secure all screws. Check regularly that the screws are still secure as mechanical oscillation and bearing pressure can lead to them becoming loose.
- Plug in the power source. Observe that the appliance is working correctly during initial use.

Figure 1: Mounting bracket (wall bracket) and anchor dowels provided. Connection from the wall to the infrared heater

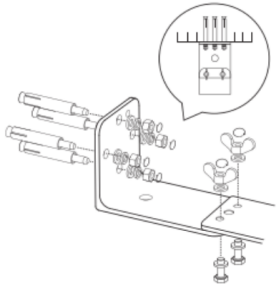

Figure 2: Min. distance from the floor, ceiling and wall

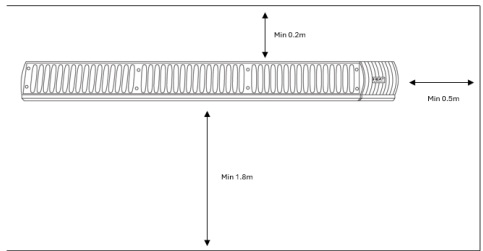

Figure 3: Tilt angle

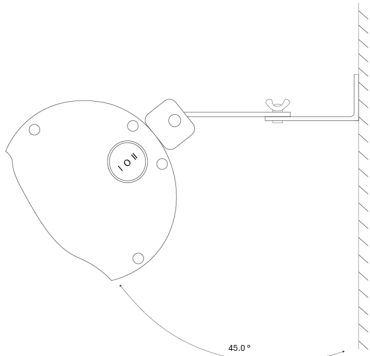



Figure 4: Max. remote distance



Specifications

Specification	901786, 901787
Voltage (V)	220-240 V
Power Consumption (W)	1300W, 2000 W
IP Rate	IP65
Infrared receiving angle	60° +/-5

Remote Control Instructions

	Button	Function	Feature
	On	On	1) Turn on the heater 2) Receiver light in heater will turn red with 100% power output
	Off	Off	1) Turn off the heater 2) The receiver light will flash in a red colour if the heater connects to the power supply. There will be no indication after cutting off the electricity
<ul style="list-style-type: none">• Use 2 AAA size 1.5V batteries in the remote control. Remove the battery when not in use for a long time, helping prolong the lifespan of the remote.• Please contact a service agent for further help if needed.• The remote-control function may be out of range if there is a barrier between the remote and the heater.			

Cleaning and Maintenance

- Before cleaning, remove the plug from the power outlet and wait until the appliance had cooled off.
- Wipe the appliance with only clean and lint-free cloths.
- Never use abrasive cleaners, scrubbing brushes and chemicals for cleaning
- To protect against electrical shock, do not immerse the cord, plug or any part of the appliance in water.
- For heating element replacement, please contact the manufacturer or a qualified person.

Disposal



This marking indicates that this product should not be disposed with other household waste throughout the EU. To prevent possible harm to the environment or human health from uncontrolled waste disposal, recycle it responsibly to promote the sustainable reuse of material resources. To return your used device, please use the return and collection systems or contact the retailer where the product was purchased. They can take this product for environmental safe recycling.

Customer Service

Repairs must be carried out by authorized specialists, thus ensuring electrical safety. Please contact suitably qualified electrician. Improper repairs could lead to danger.

This warranty does not cover damage or failure which results from alteration, accident, misuse, abuse, neglect, commercial use or improper maintenance.

In line with our policy of continuous product development, we reserve the right to change the product and documentation without notice.



Heat Outdoors

Unit 9, Stort Valley Industrial Estate
Stansted Road, Bishop's Stortford
Hertfordshire, United Kingdom
CM23 2TU

www.heat-outdoors.co.uk

01279 466500

info@heat-outdoors.co.uk